



**Mayorswell Street, Claypath, DH1 1LQ**  
**3 Bed - Student Property**  
**£172 Per Week**

**ROBINSONS**  
SALES • LETTINGS • AUCTIONS • SURVEYS

**\*\* STUDENT PROPERTY -- BILLS EXCLUDED \*\***

The floor plan comprises of entrance hallway, living/possible bedroom, lounge dining room, kitchen. The first floor has three bedrooms and shower broom/wc. Outside there is a small front garden and rear enclosed yard with gated access.

Mayorswell Street is within walking distance to the city centre which has a wide range of shops, recreational facilities, bars, restaurant, theatre and cinema. There are also good motoring links nearby including the A1(M) highway providing access to major towns and cities in the North and South.

EPC Rating - D

BOND £400 | £172 PER WEEK PER STUDENT | 12 MONTHS TENANCY

## **GROUND FLOOR**

### **Hallway**

### **Lounge or Poss. Bedroom (subject to permissions)**

11'09 x 10'0 (3.58m x 3.05m)

### **Living Dining Room**

17'01 x 12'02 (5.21m x 3.71m)

### **Kitchen**

14'06 x 4'11 (4.42m x 1.50m)

## **FIRST FLOOR**

### **Bedroom**

13'09 x 12'08 (4.19m x 3.86m)

### **Bedroom**

10'03 x 8'01 (3.12m x 2.46m)

### **Shower Room/WC**

6'05 x 5'07 (1.96m x 1.70m)



# OUR SERVICES

Mortgage Advice

Conveyancing

Surveys and EPCs

Property Auctions

Lettings and Management

Strategic Marketing Plan

Dedicated Property Manager

Mayorswell Street

Approximate Gross Internal Area  
889 sq ft - 83 sq m

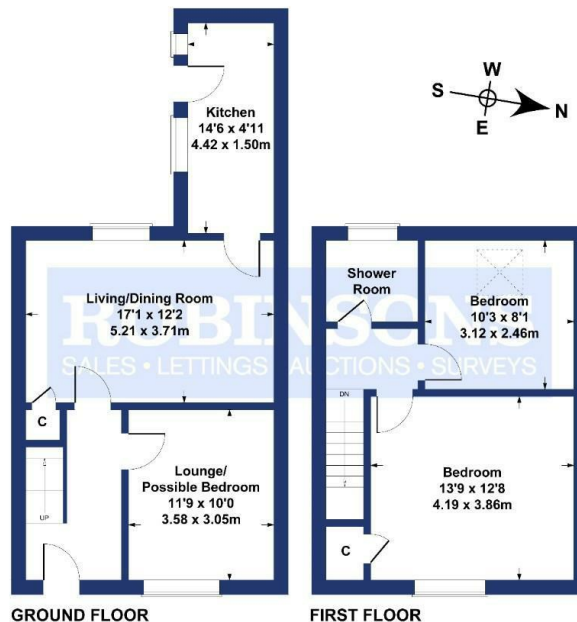

GROUND FLOOR

FIRST FLOOR

SKETCH PLAN FOR ILLUSTRATIVE PURPOSES ONLY

All measurements walls, doors, windows, fittings and appliances, their sizes and locations, are approximate only. They cannot be regarded as being a representation by the seller, nor their agent.

Produced by Potterplans Ltd. 2023

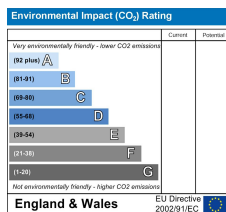
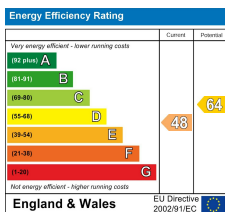

## DURHAM

1-3 Old Elvet  
DH1 3HL

T: 0191 386 2777 (Sales)

T: 0191 383 9994 (option1) (Lettings)

E: info@robinsonsdurham.co.uk

## DURHAM REGIONAL HEAD OFFICE

19A old Elvet  
DH1 3HL

T: 0191 383 0777

E: info@robinsonsdurham.co.uk

## CHESTER-LE-STREET

45 Front Street  
DH3 3BH

T: 0191 387 3000

E: info@robinsonscs.co.uk

## BISHOP AUCKLAND

120 Newgate Street  
DL14 7EH

T: 01388 458111

E: info@robinsonsbishop.co.uk

## CROOK

Royal Corner  
DL15 9UA

T: 01388 763477

E: info@robinsonscrook.co.uk

## SPENNYMOOR

11 Cheapside  
DH16 6QE

T: 01388 420444

E: info@robinsonsspenny Moor.co.uk

## SEDFIELD

3 High Street  
TS21 2AU

T: 01740 621777

E: info@robinsonssedgefield.co.uk

## WYNYARD

The Wynd  
TS22 5QQ

T: 0174 064 5444

E: info@wynyardfineandcountry.co.uk

Every care has been taken with the preparation of these particulars, but they are for general guidance only and complete accuracy cannot be guaranteed. If there is any point, which is of particular importance please ask or professional verification should be sought. All dimensions are approximate. The mention of fixtures, fittings &/or appliances does not imply they are in full efficient working order. Photographs are provided for general information and it cannot be inferred that any item shown is included in the sale. These particulars do not constitute a contract or part of a contract.

Robinsons can recommend financial services, surveying and conveyancing services to sellers and buyers. Robinsons staff may benefit from referral incentives relating to these services.



# ROBINSONS

SALES • LETTINGS • AUCTIONS

1 Old Elvet, Durham City, Durham, DH1 3HL | Tel: 0191 383 9994 | info@robinsonsdurham.co.uk

www.robinsonsestateagents.co.uk